

# Explosionszeichnung

Saladette  
KBS 904

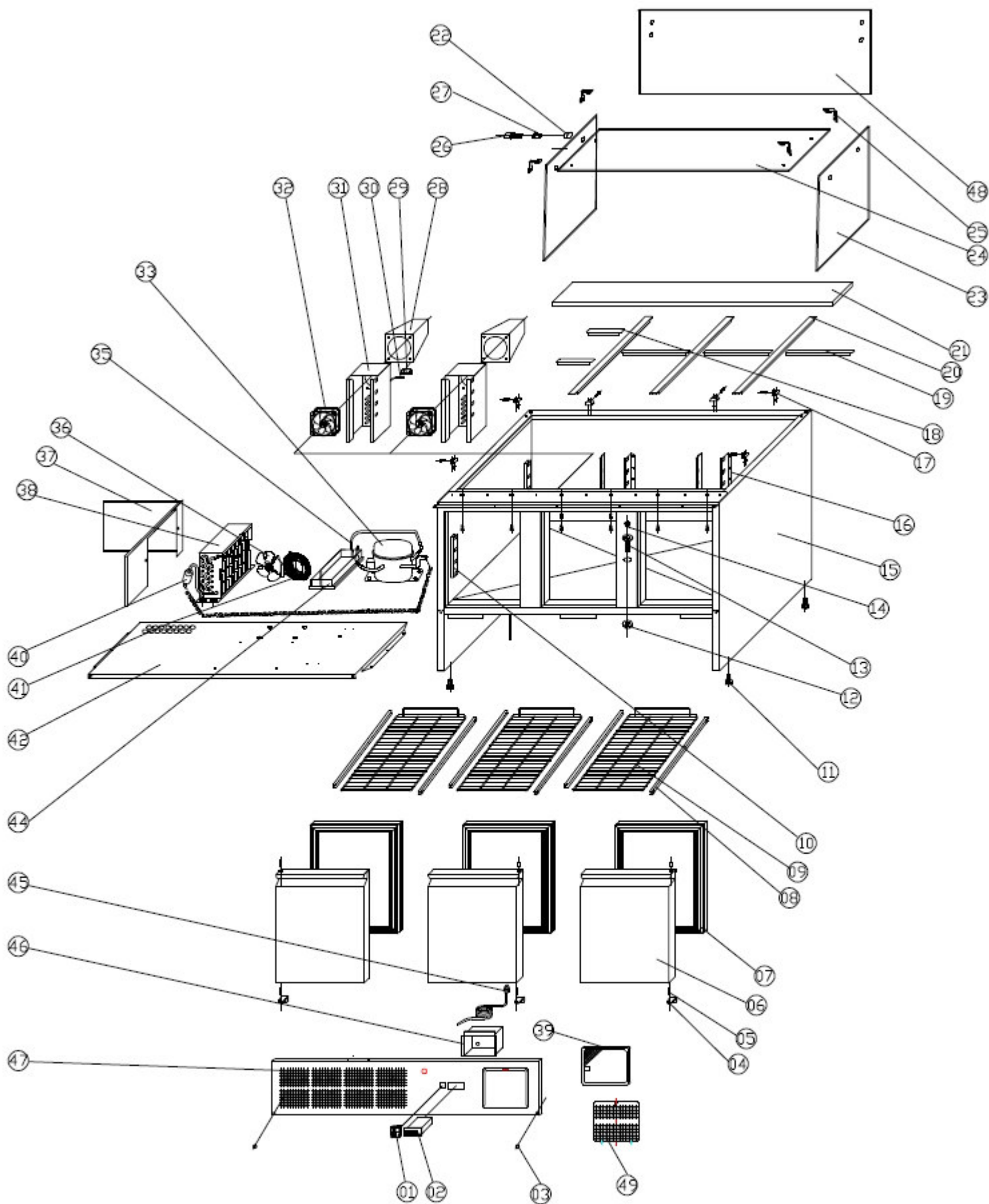

KBS Gastrotechnik GmbH - Johannes-Kepler-Str. 14 - 55129 Mainz



## SPARE PARTS LIST

| <b>NØ.</b> | <b>CODE</b> | <b>NAME</b>             | <b>MODEL</b> | <b>QUY.</b> |
|------------|-------------|-------------------------|--------------|-------------|
| 1          | S900.01     | MAIN SWITCH             | DRH-2415-3   | 1PC         |
| 2          | S900.02C    | THERMOSTAT              | XR02CX       | 1PC         |
| 3          | S900.03     | PLASTIC CAP             | Φ13          | 8PCS        |
| 4          | S900.05     | DOWN HINGE/RIGHT/LEFT   |              | 3PCS        |
| 5          | S900.06     | DOWN HINGE AXIS         |              | 6PCS        |
| 6          | S900.07     | DOOR RIGHT/LEFT         |              | 3PCS        |
| 7          | S900.08     | GASKET                  |              | 3PCS        |
| 8          | S900.10     | GUIDE/RIGHT/LEFT        |              | 3PAIRS      |
| 9          | S900.11     | SHELF                   | GN1/1        | 3PCS        |
| 10         | S900.12     | SIDE SUPPORT/RIGHT/LEFT |              | 4PCS        |
| 11         | S900.13     | FEET                    |              | 4PCS        |
| 12         | S900.14     | DRAIN PIPE NUT          |              | 1PC         |
| 13         | S900.15     | DRAIN PIPE              |              | 1PC         |
| 14         | S900.16     | DRAIN PIPE COVER        |              | 1PC         |
| 15         | S903.01     | BODY                    |              | 1PC         |
| 16         | S900.18     | BACK SUPPORT/RIGHT/LEFT |              | 2PAIRS      |
| 17         | VRX.02      | GLASS.CLIP              |              | 1PAIR       |
| 18         | S900.20     | SHORT SUPPORT           |              | 2PCS        |
| 19         | S900.21     | MIDDLE SUPPORT          |              | 3PCS        |
| 20         | S900.22     | LONG SUPPORT            |              | 3PCS        |
| 21         | S903.02     | CUTTING BOARD           |              | 1PC         |
| 22         | VRX.07      | GLASS FIXED CLIP NUT    |              | 2PCS        |
| 23         | S900.GS.01  | SIDE GLASS              |              | 2PCS        |
| 24         | S903.GS.03  | TOP GLASS               |              | 1PC         |
| 25         | VRX.06      | GLASS LINKED CLIP       |              | 1PC         |
| 26         | VRX.05      | GLASS FIXED BOLT        |              | 4PCS        |
| 27         | VRX.04      | BUSHING                 |              | 4PCS        |
| 28         | S900.30     | AIRFLOW DUCT            |              | 2PCS        |
| 29         | S900.31     | SENSOR FIXED CLIP       |              | 1PC         |
| 30         | S900.32     | SENSOR                  |              | 1PC         |
| 31         | S900.33     | CIRCLE FAN SUPPORT      |              | 2PCS        |
| 32         | S900.34     | CIRCLE FAN              | SA1238A2     | 2PCS        |
| 33         | G-S903.01   | COMPRESSOR              | HPKD190A     | 1PC         |

|    |                  |                       |                              |     |
|----|------------------|-----------------------|------------------------------|-----|
| 35 | S903.02          | DISCHARGE TUBE        | Φ6                           | 1PC |
| 36 | GN650TN.34       | CONDENSER FAN         | CA01-01/Φ200                 | 1PC |
| 37 | S903.06          | CONDENSER COVER BOARD |                              | 1PC |
| 38 | GN650TN.38       | CONDENSER             |                              | 1PC |
| 39 | U-GN2100TN(HT11) | FILTER                | 230×208                      | 1PC |
| 40 | S900.44          | FILTER DRIER          | 25g                          | 1PC |
| 41 | GN650TN.46       | BASKET GUARD GRILLS   | Φ246                         | 1PC |
| 42 | S903.09          | UNIT BOARD            |                              | 1PC |
| 44 | S900.40A         | WATER PAN             |                              | 1PC |
| 45 | S900.47          | PLUG                  | LT312/1.5MM <sup>2</sup> ×3G | 1PC |
| 46 | S900.48          | JUNCTION BOX          | LT312/1.5MM <sup>2</sup> ×2G | 1PC |
| 47 | S903.11J9        | FRONT PANEL           |                              | 1PC |
| 48 | S903.GS.02       | BACK GLASS            |                              |     |
| 49 | S903.12          | SCREEN FILTER SUPPORT | 过滤网挡板(J9)                    | 1PC |