

Explosionszeichnung

Bäckerei Kühlschrank
KU 800 CNS

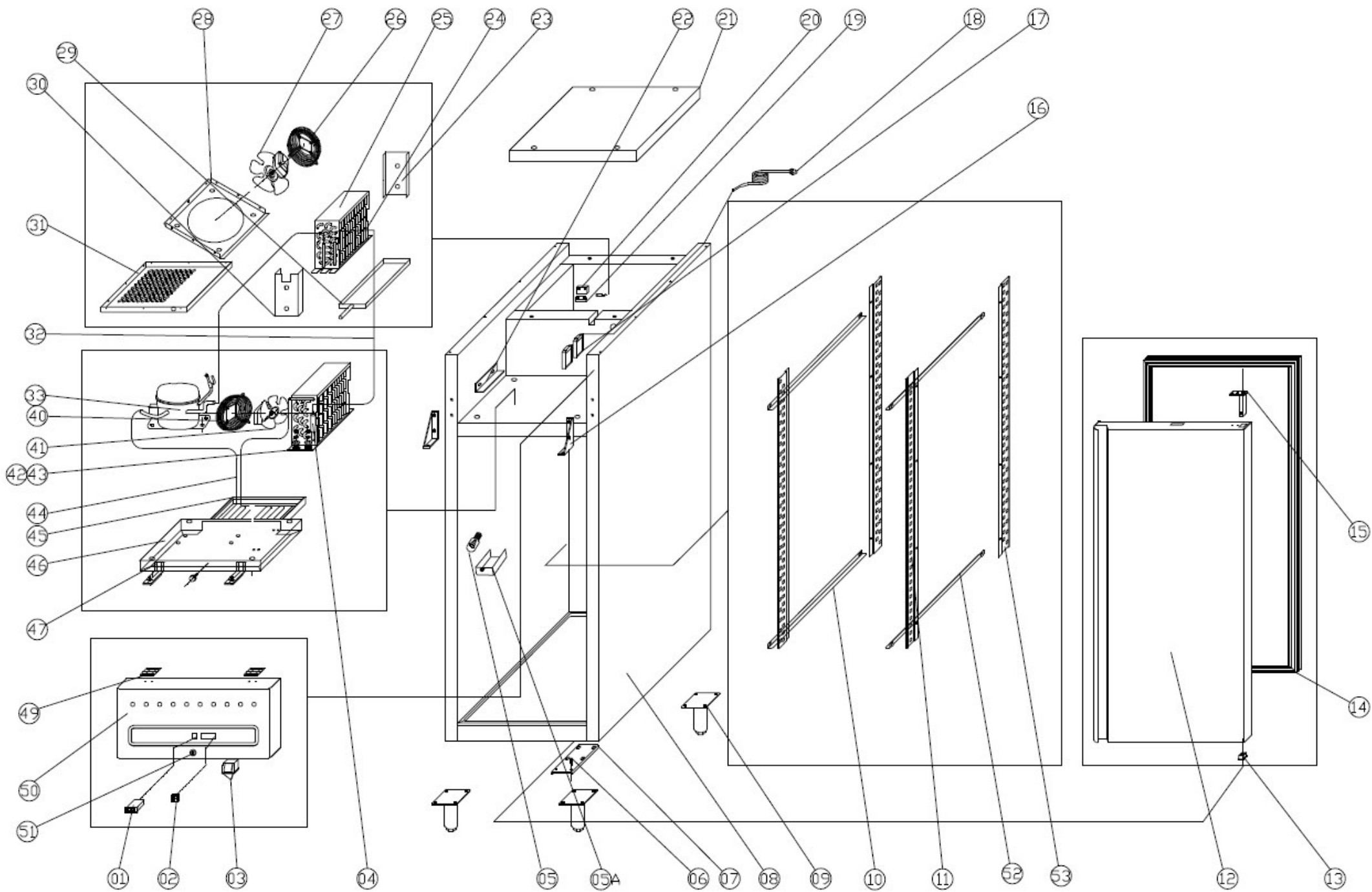

KBS Gastrotechnik GmbH - Schoßbergstraß 26 - 65201 Wiesbaden



SPARE PARTS LIST

| NO. | CODE | NAME | MODEL | QTY. |
|-----|-------------|------------------------|-------------------------------|-------|
| 1 | S900.02 | THERMOSTAT | XR02CX | 1PC |
| 2 | S900.01 | MAIN SWITCH | DRH-2415-3 | 1PC |
| 3 | GN650TN.48 | DOOR SWITCH | | 1PC |
| 4 | GN1410TN.14 | FILTER DRAYER | 25g | 1PC |
| 5 | GN650TN.02 | LAMP | 15W | 1PC |
| 6 | S900.06 | DOWN HINGE AXIS | | 1PC |
| 7 | GN650TN.05 | DOWN HINGE | | 1PC |
| 8 | PA800TN.12 | BODY | | 1PC |
| 9 | GN650TN.53 | WHEEL | 4" | 2PC |
| 9 | | | | 2PC |
| 10 | PA800TN.02L | GUIDE LEFT | 794×32 | 10PCS |
| 11 | PA800TN.03 | FRONT SUPPORT | | 2PCS |
| 12 | GN650TN.11 | DOOR | | 1PC |
| 13 | GN650TN.10 | DOWN HINGE AXIS JACKET | | 1PC |
| 14 | GN650TN.13 | GASKET | | 1PC |
| 15 | GN650TN.14 | DOOR SPRING | | 1PC |
| 16 | GN650TN.15 | UP HINGE LEFT | | 1PC |
| | | UP HINGE RIGHT | | 1PC |
| 17 | GN650TN.16 | JUNCTION BOX | | 2PCS |
| 18 | S900.47 | PLUG | LT312/1.5MM ² ×3GL | 1PC |
| 19 | GN650TN.17 | PROBE PADDING | | 1PC |
| 20 | S900.31 | SENSOR FIXED CLIP | | 1PC |
| 21 | PA800TN. 04 | TOP | | 1PC |
| 22 | GN650TN.18 | FIXING STRIP | | 1PC |
| 23 | GN650BT.03 | EVAPORATOR BACK GUIDE | | 1PC |
| 24 | PA800TN.06 | EVAPORATOR | | 1PC |
| 25 | PA800TN.07 | EVAPORATOR COVER | | 1PC |
| 26 | GN650TN.23 | WALL RING | | 1PC |
| 27 | GN650BT.11 | EVAPORATOR FAN | CA03-51/Φ230 | 1PC |
| 28 | PA800TN.08 | FAN SUPPORT | | 1PC |
| 29 | PA800TN.05 | EVAPORATOR WATER PAN | | 1PC |
| 30 | GN650BT.07 | EVAPORATOR FRONT GUIDE | | 1PC |
| 31 | PA800TN.09 | AIRFLOW DUCT BOARD | | 1PC |
| 32 | S900.43 | CAPILLARY | Φ1.15×3000 | 1PC |

| | | | | |
|----|-------------------|---------------------------|--------------|-------|
| 33 | G-F500.01 | COMPRESSOR | EMT2121U | 1PC |
| | S903.05A- NE1121Z | COMPRESSOR | NE1121Z | 1PC |
| | S903.05D- NL8.4MF | COMPRESSOR | NL8.4MF | 1PC |
| 40 | GN650TN.46 | BASKET GUARD GRILLS | | 1PC |
| 41 | GN650TN.34 | CONDENSER FAN | CA01-01/Φ200 | 1PC |
| 42 | S903.08 | FILTER | 205×218 | 1PC |
| 43 | GN650TN.38 | CONDENSER | | 1PC |
| 44 | GN650TN.40 | DISCHARGE TUBE | | 1PC |
| 45 | GN650TN.41 | CONDENSATE EVAPORATOR PAN | | 1PC |
| 46 | GN650TN.42 | UNIT BOARD | | 1PC |
| 47 | GN650TN.43 | FRONT PANEL FIXED CLIP | | 2PCS |
| 49 | GN650TN.44 | HINGE | | 2PCS |
| 50 | GN650TN.45 | FRONT PANEL | | 1PC |
| 51 | GN650TN.86 | LOCK | | 1PC |
| 52 | PA800TN.02R | GUIDE RIGHT | 794×32 | 10PCS |
| 53 | PA800TN.10 | BACK SUPPORT | | 2PCS |